

INSTALLATION INSTRUCTIONS & PART DIAGRAM
STANDARD LIGHT WEIGHT HARDWARE

MODEL AL-125-2

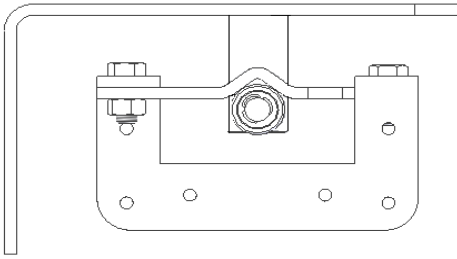

NOTE: BRACKET MOUNTS ON TOP OF BEARING PLATE

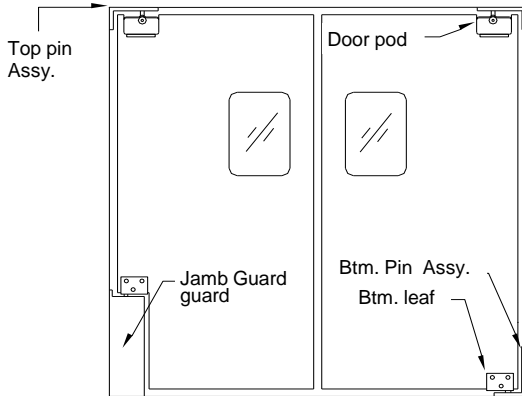

NOTE: Bottom pin assembly must be secured to floor

JAMBS MUST BE SQUARE AND PLUMB
A MINIMUM OF 3-1/2 INCH WIDE JAMBS
REQUIRED TO MOUNT HARDWARE

1. Measure width and height of framed opening and compare width dimensions given at time of ordering. (This model was cut to the dimensions given by the customer and is not adaptable to fit into a different size opening.)
2. Position bottom pin assembly on floor and center on side jamb. Secure to jamb using (4) 1-1/2" screws supplied. Bottom pin must be secured to floor using (2) 3/8" X 2-1/4" floor anchors supplied. Top pin assembly secures to top with (4) screws and side jamb with (2) screws supplied.
3. If a jamb guard is supplied, refer to the installation instructions supplied with the jamb guard.
4. Slip door over bottom pin and lift slightly to slide door pod over bearing plate. Line up holes and insert bolts supplied. Partially install lock nuts, move door to closed position and secure lock nuts.
5. To install covers, remove the (2) center bolts / nuts in top door bracket. Position both covers and replace the (2) center bolts / nuts back into original holes.

NOTE: HOLLOW METAL JAMBS DRILL 7/32 PILOT HOLE FOR 9 GA. AND THINNER MATERIAL

- Top Pin Assy
 - (6) 1/4" - 20 x 1" phil. flt hd. thread cutting screws
 - (6) #14 - 1 - 1/2" phil. flt hd. sheet metal / wood screws

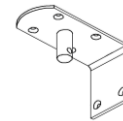

- Bearing Plate with (2) 5/16 - 18 screws, (2) 5/16 - 18 lock nuts



- 3/8" Axle 

- (2) Rollers 

- Klipring 

- (2) Aluminum Covers, fasteners secured to door (AL Door)
- OR
- (2) SS Covers, fasteners secured to door (SS Door)



- Bottom Pin Assy (4) of each fastener listed under Bottom Pin & (2) floor anchors
(Bottom Pin NOT included if jamb guards are used)

- Plastic Bushing Sleeve
(If jamb guard is used will ship loose, add to jamb guard in field)

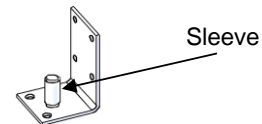

2720 E. Avalon Ave.
Muscle Shoals AL, 35661
Telephone: 800-633-3120
Fax: 800-750-9616
email: info@aleco.com
web: www.aleco.com